

# **Cordless Steam Wet & Dry Vacuum Cleaner**

## **Cordless Flomo SE**

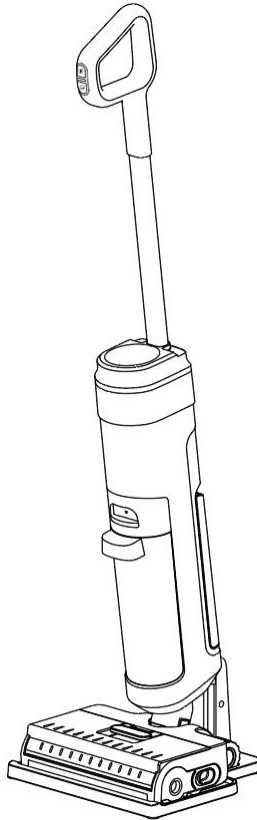

## **User Manual**

Please read this manual carefully before use and keep the manual for future reference.

## CONTENTS

Important Tips .....	1
Specifications .....	4
Package Contents .....	4
Product Overview .....	5
Handle Installation Instructions .....	7
Charging Instructions .....	8
Self-Drying the Roller Brush (optional) .....	8
Starting to Use .....	9
Filling the Clean Water Tank .....	11
Clean the Dirty Water Tank .....	12
Clean the Filter .....	13
Clean the Brush Guard .....	13
Clean the Roller Brush .....	14
Troubleshooting .....	15
Recommended Cleaning / Replacement Frequency .....	17
Warranty .....	18
Battery Disposal and Removal .....	18
Compliance Standards .....	20

## IMPORTANT TIPS

READ ALL THE INSTRUCTIONS BEFORE USE. Failure to follow the warnings and instructions may result in electric shock, fire, and/or serious injury.

### Warning

#### **To reduce the risk of fire, electric shock, or injury:**

- Use only as described in this user manual. Use only the accessory parts which original manufacturer provided or suggested.
- Only for indoor use, on the hard floor or carpet with short hair.
- Do not allow to be used as a toy. Please pay more attention when children or pets are nearby
- Do not touch charger or its charging pins with wet hands during charging.
- The steam is high temperature, please keep it away from children, animals and your body parts.
- Do not immerse the appliance in liquid.
- Do not use without the filter.
- Pay much attention when cleaning on the stairs.
- Ensure the switch is at the off-position before picking up or carrying the appliance.
- This appliance can not be used by children aged 8 years and under, or persons with reduced physical, sensory, or mental capabilities. People who is lack of experience must have safety instruction before they use the appliance to keep them aware the hazards involved. Children shall not play with, use or clean or repair the appliance if they are without supervision.
- Turn OFF and plug out from electrical outlet if the appliance will not be used for a long time.
- Always clean the dirty water tank after each use to prevent blockages, which may lead to low suction power, motor overheating, or reduce the service life of the appliance.

- Store the appliance at a shaded and dry place after each use.
- Do not use the appliance when the water depth is more than 5mm on the surface.
- Do not place or dip appliance into water or try to clean flooded areas.
- Plastic packing bag is dangerous. To avoid from the suffocation, please keep the children away from it.
- Only use the type and amount of liquid specified under the operation section of this guide.
- Do not use the damaged cord or plug. If the cord or plug is damaged, it must be replaced by Mamibot, or its service agent or qualified persons.
- Do not use the appliance to pick up any hazardous material or chemicals, such as solvent, drain cleaner, strong acids, or strong alkali.
- Do not use the appliance in any closed space filling with vapour given off by oil-based paint, paint thinner, some moth-proofing substances, flammable dust, or other explosive or toxic vapour.
- Do not use the appliance to pick up anything that is burning or smoking, such as cigarettes, matches or hot ashes.
- Do not use the appliance to pick up sharp objects, such as metallic nails, pieces of glass, metal paper clips, or pins.
- Stop using immediately if the appliance is overheating, making unusual noises, producing unusual odors.
- To avoid the charging base from short-circuited, do not use it if any damage for its cable or charger.
- Keep the charger and its wire far away from heated surfaces, such as fireplace or heater, to avoid from any deformation.
- To grasp the charger to plug off it, instead of grasping its cable.
- Do not use the appliance when it is damaged or modified.  
Damaged or modified batteries may cause fire, explosion or risk of injury.

- Do not use the appliance at the environment of fire or excessive temperature above 40° C, it may cause an explosion.
- Follow all instructions when charging the appliance.
- The appliance is only to be used with the power supply unit provided with the appliance.

## **Important Safety Points**

- Only qualified service people will be allowed to repair the appliance. And only appointed replacement parts be allowed to be used.
- Do not attempt to modify any parts of the appliance.
- Do not use or store or charge the appliance in extremely hot or cold environment (below 0°C /32° F or above 40° C/104° F).
- If the appliance has ever been dropped, damaged, left outdoors, or dropped into water, can not work as its usual, please return it to the service center.
- The appliance is only to be used with the original power supply unit provided with the appliance.

## **About Cleaning**

- 1) If large amount of cleaning liquid entering into the motor, it may cause damage to the appliance.
- 2) Do not use any acidic or alkaline liquid to the appliance.
- 3) If any chemical liquid into the eyes, immediately flush them with clean water.
- 4) Dirty water disposal should comply with local regulations.

## Specifications

Product Name	Cordless Steam Wet & Dry Vacuum Cleaner
Model No.	Cordless Flomo SE
Size of Main Unit	270*225*1180 mm
Charging Voltage	27V $\overline{\text{---}}$ 1.2A
Rated Power	450W
Working Mode	Steam mode, Wet mopping mode, Dry mopping mode, Turbo mode
Battery Type	Rechargeable Li-ion
Battery Capacity	4000mAh 86.4Wh
Working Time	Standard mode $\geq$ 35min Steam mode $\geq$ 13min Turbo mode $\geq$ 28min
Charging Time	4-6H
Clean Water Tank Capacity	About 600 ml
Dirty Water Tank Capacity	About 800 ml

Data provided by the lab of Mamibot Manufacturing USA Inc.

\*1 Specifications are subject to change without notice.

\*2 Performance data is obtained under specific laboratory conditions. Actual results may vary based on usage, environment, battery age, and other factors. For the location of buttons and components, please refer to the physical product.

## Package Contents

Main Unit x 1 pcs	Handle x 1 pcs	Screw & Screw Driver x 1 set
Adapter x 1 pcs	Roller Brush x 1 pcs	Charging Base x 1 pcs
HEPA x 1 pcs	Cleaning Tool x 1pcs	User Manual x 1 pcs
Strainer (wet and dry separator) x 1pcs		

## PRODUCT OVERVIEW

### Product Introduction

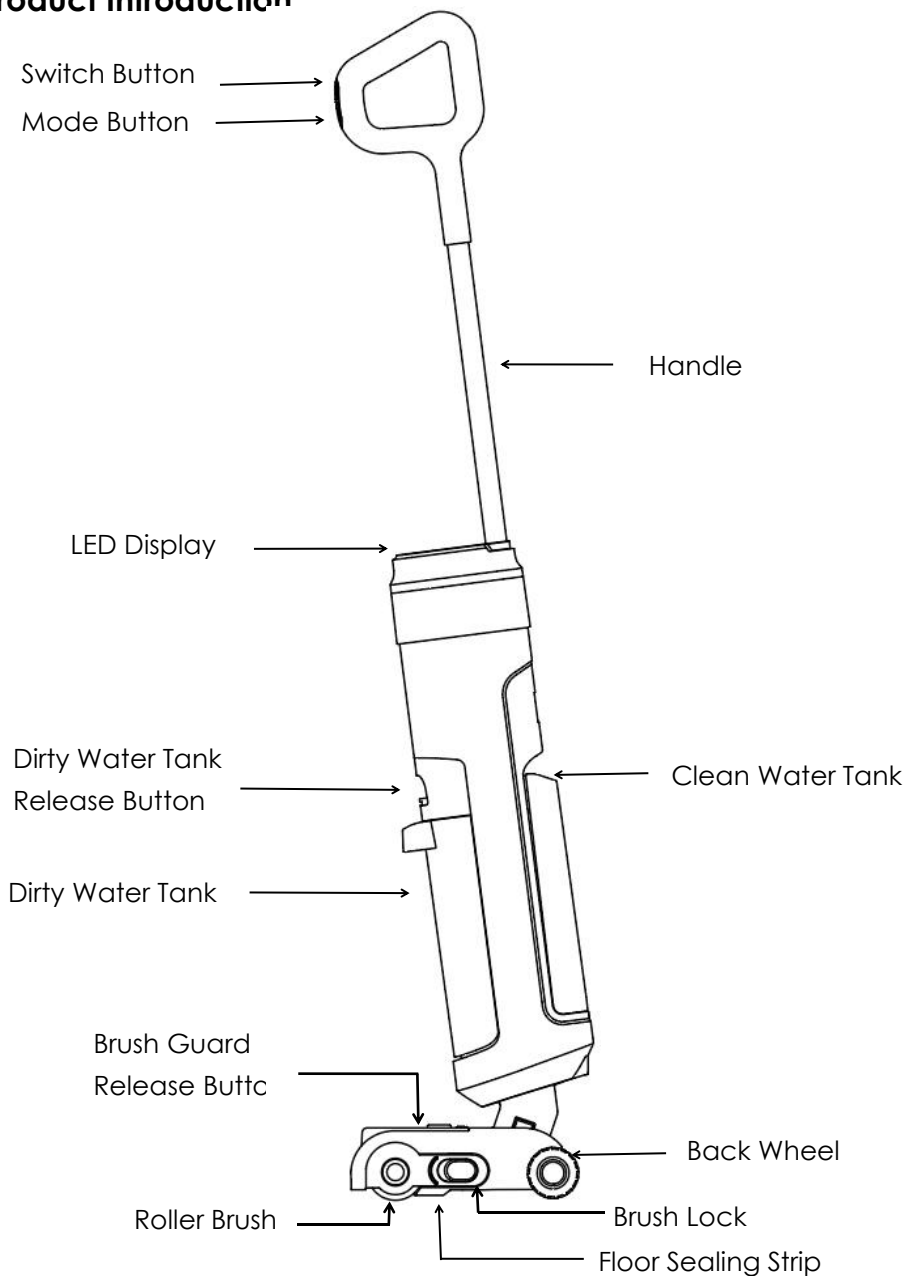

## Charging Base

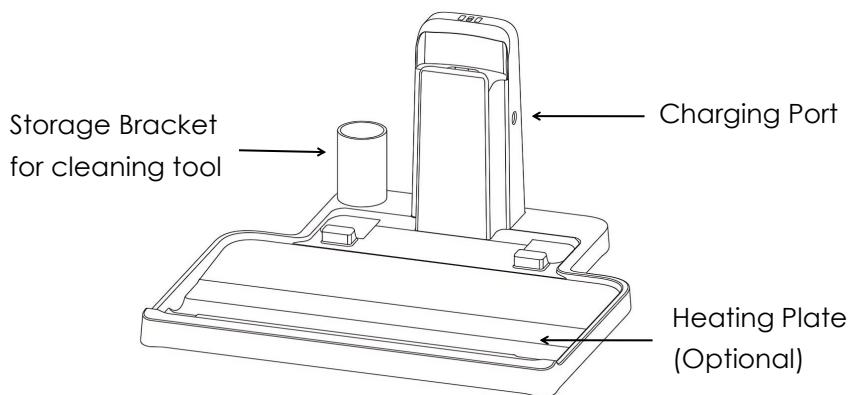

## Display Screen

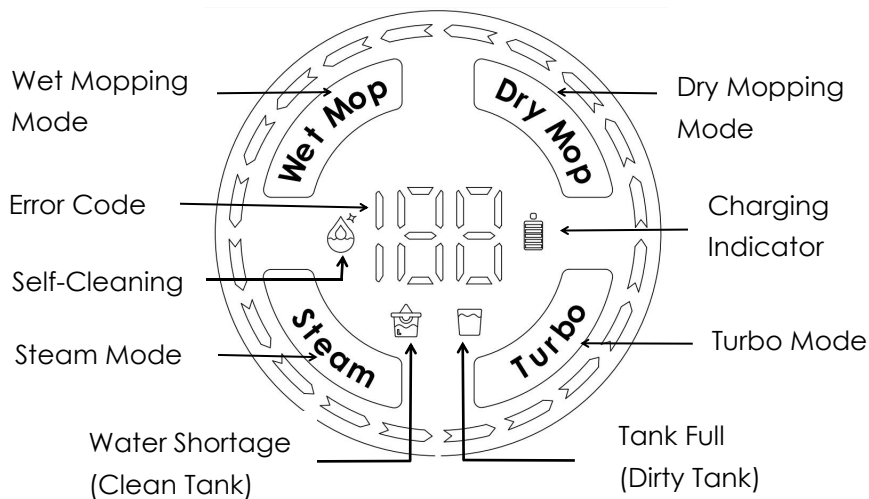

**Note:** The illustrations in this manual are for reference only.



## Handle Installation Instructions

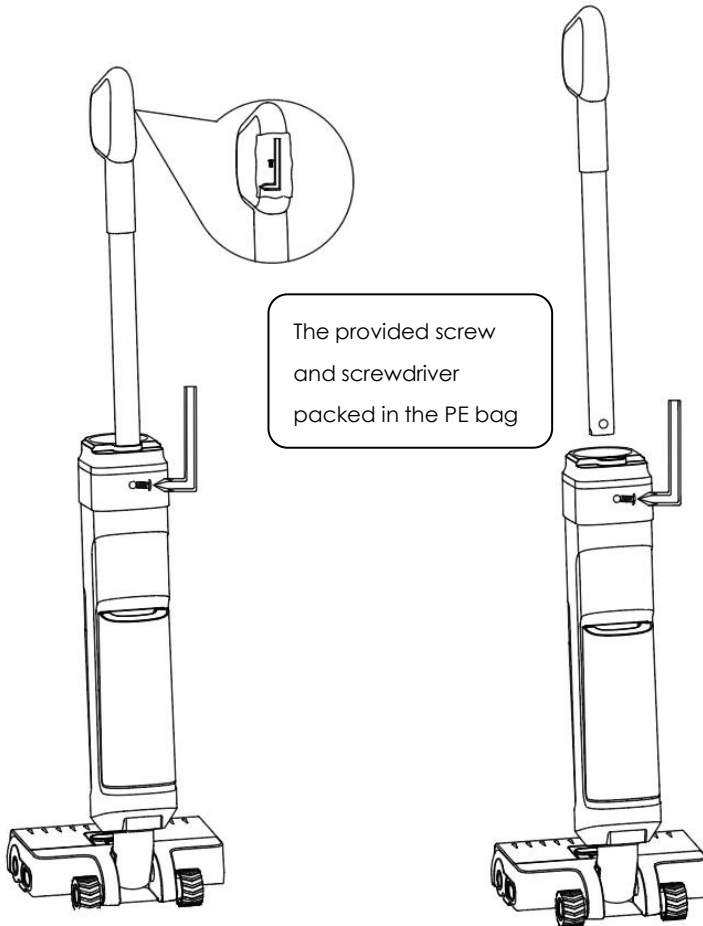

1. Insert the handle into the body of the appliance.
2. Tighten the screw with the screwdriver to secure the handle.

Ensure the handle is firm without any looseness.

3. If you want to unload the handle, please remove the screw on the back of the appliance, and pull the handle out.

## Charging Instructions

**Note:** Please fully charge the appliance before using it for the first time.

### Charging

1. Please place the appliance on the charging base close to the wall.
2. Plug the adapter into power socket and connect the wire end to the charging port on the appliance.
3. When the charging indicator on the display screen blinks, it means the appliance is charging.

### Self-Drying the Roller Brush (optional)

1. The self drying function will be automatically started once the system detected the appliance was been put back to the charging base.
2. The heating temperature will not be more than 45°C and the drying time will not be longer than 12hrs. During the drying time, the roller brush will rotate once every 45 mintues.
3. **WARM TIPS :** Plug in the base first, then place the unit on it, then 12 hours later the device will stop heating to the roller brush. If firstly putting the unit on the charging base and then plug in the base, the heating function to the roller brush will be stopped once the unit was fully charged.

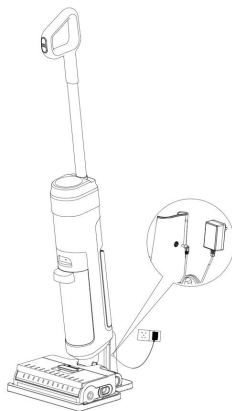



**Note:**

- Only the supplied adapter will be permitted to charge the appliance.
- The appliance must be charged once every 3 months if it will not be used for an extended period. It will take 4-6 hours for each full charge.



## Starting to Use

**Note: Please charge the appliance before first time use. (refer to “Charging Instructions” for details).**

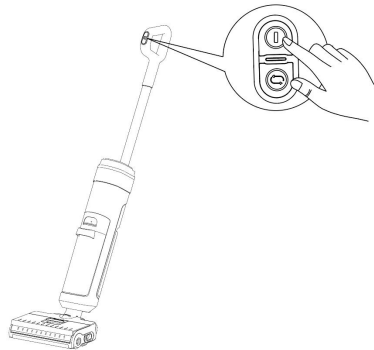

Hold and press the button  for 2 seconds to power the device on. Press the button  again for 1 second, the appliance will start AUTO cleaning mode. Hold and press it for 2 seconds again to power off the device.

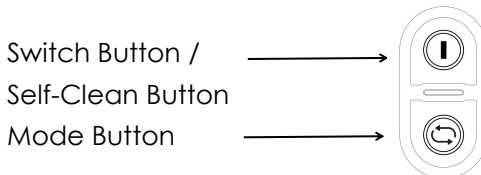

### Cleaning modes/Voice on/off:

1. Press the Mode button  to cycle through the cleaning modes in the following order: Wet Mopping → Steam Mode → Dry Mopping.
2. Hold and press mode button  for 2 seconds, enter Turbo Mode, press again to cancel.



3. Hold and press the switch button  and mode button  for 3 seconds to turn on or turn off the voice.

**Note:** Do not recline the device more than 140° to prevent from water leakage.

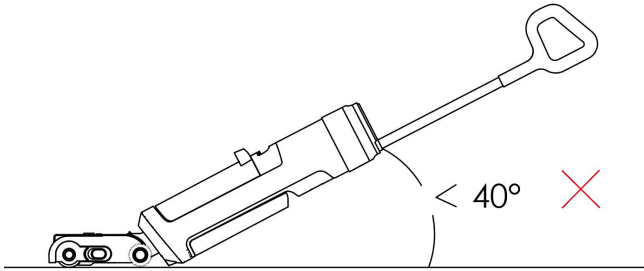

Place the device on the charging base vertically after use for recharge and storage.

## One Touch Self-Cleaning

**The self-cleaning function can only be initiated when the device is on the charging base AND the battery level is above 10%.**

1. The device upright sit on the charging base and make sure the clean water tank is full.
2. Short press the self-clean button (I) on the handle, the self-cleaning indicator on the led display will be on, then the self-cleaning starts.
3. The device will continue to recharge after the self-cleaning is done. Please clean the dirty water tank in time.

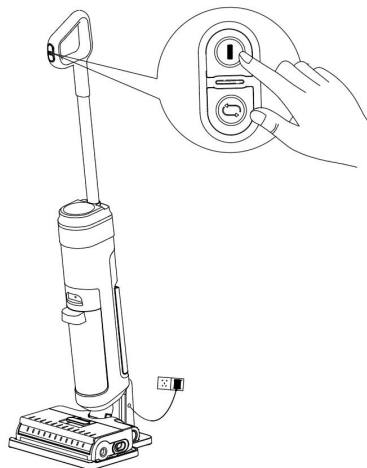

## Filling the Clean Water Tank

① Hold the device and take out the clean water tank by pressing the water tank release button.

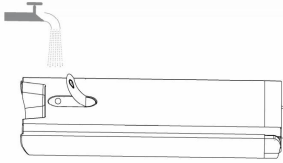
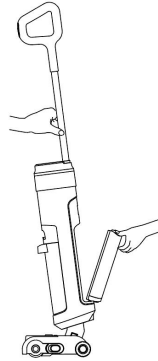

② Fill the clean water: Close the rubber lid firmly after adding water.

**Note:**

- Only use water below 140F° /60C° .
- DO NOT USE HOT WATER.
- Don't beyond the water warning line.

③ Place the tank back to the device.  
Please be sure the tank is well placed.

**Note:**

- Do not add dirty water into the clean water tank.
- Do not add corrosive or flammable liquids into the water tank.
- It is normal if there is some water in the water tank at the first use, tests and inspections are proceeded before goods leaving factory.

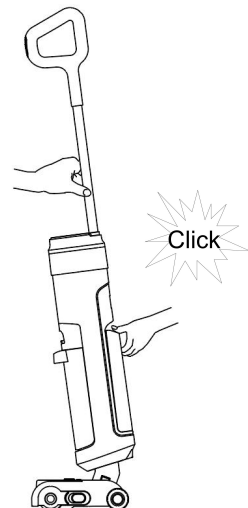

## Clean the Dirty Water Tank

**Note:** It is suggested to empty the dirty water tank after each self-cleaning done.



① Hold the device and take the dirty water tank out by pressing dirty water tank release button.

② Hold the tank with one hand and pull up the lid with another hand to empty the dirty water. Use the **strainer** to separate the wet and dry waste.

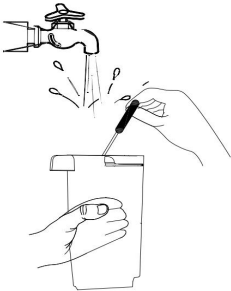
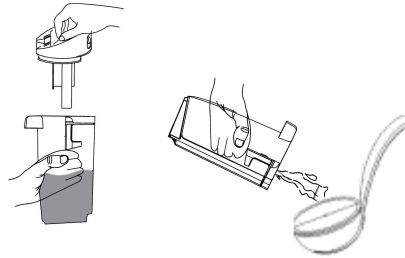

③ Flush the tank and its lid with clean water. Clean the inner wall of the tank with the provided cleaning tool.

④ After the cleaning done, put the water tank back. Please be sure the tank is well placed.

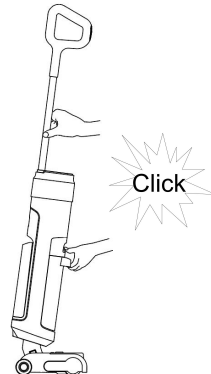

## Clean the Filter

**Note: It is suggested to clean the filter after each use.**

Remove the filter from the top of the dirty water tank. Tap it slightly to drop off the dust on it, then flush it with clean water and cleaning tool, dry it after each use.

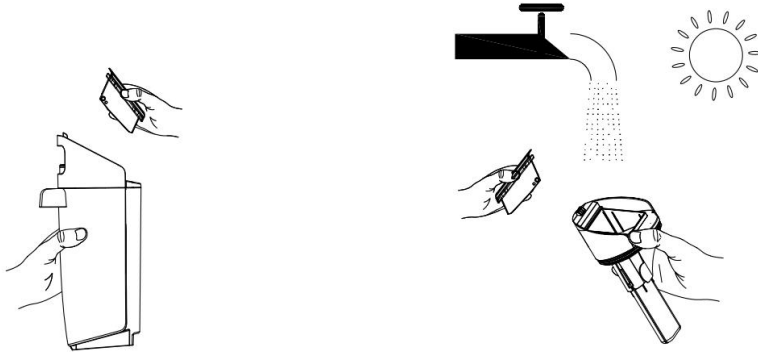

## Clean the Brush Guard

1. Remove the brush guard by pressing the brush guard release button and wash it with clean water.
2. Please load it back correctly avoid from any leakage.

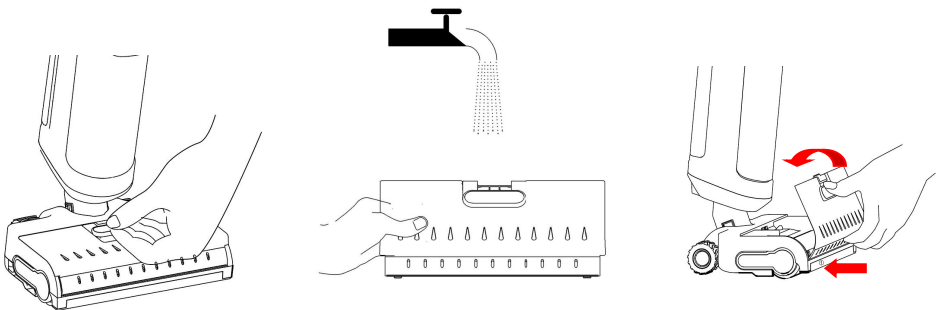

## Clean the Roller Brush

① Hold and press the roller brush release button with your thumb and index fingers, the pull out the roller brush horizontally as picture instructs.

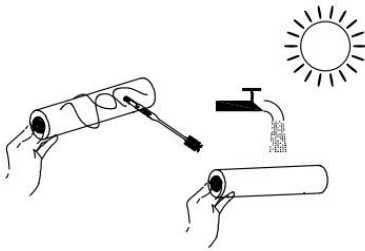
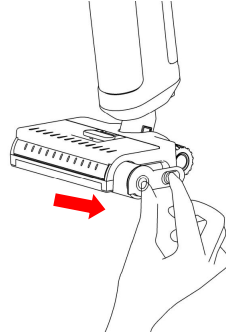

② Remove hair and debris on the roller brush with the cleaning tool, and wash it with clean water.

The roller brush must be completely dried before use.

③ Remove hair and dirties from the brush seat and suction port with a tissue or wet cloth.

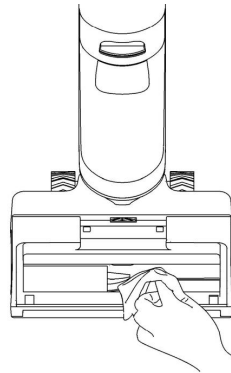
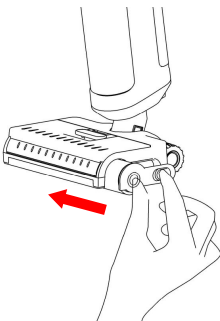



④ Push the roll brush back as picture shows after cleaning it.



## Troubleshooting

If the appliance is not working properly, the display screen will show an error code. Please refer to the trouble shooting table to find the solution.

Error Code	Possible Cause	Solution
	Dirty water tank full	Empty the dirty water tank and clean the metal conductive pole.
	Clean water tank empty	1.Please add the clean water. 2.If still keep alarming, please remove the water tank and start the unit until the machine alarms again, and then put back the water tank.
E1	Roller brush is blocked	Please remove the blockage on the roller brush.
E2	Fan motor abnormal	Please contact customer service.
04	Low battery	Charge the device.
Fail to turn on the device	1.The handle may not be placed properly. 2.The battery is low.	1.Check whether the handle is firmly inserted and locked. 2.Charge the cleaner.

The vacuum is weakness than before.	<ol style="list-style-type: none"><li>1. The HEPA is blocked or wet.</li><li>2. The pipeline is blocked.</li></ol>	<ol style="list-style-type: none"><li>1. Clean and dry the HEPA.</li><li>2. Clean the Pipeline.</li></ol>
The cleaner does not work in Self-cleaning mode.	<ol style="list-style-type: none"><li>1. The cleaner does not connect to power source.</li><li>2. The charging station does not connect to power source.</li><li>3. The dirty water tank is full.</li><li>4. There is shortage of clean water tank.</li></ol>	<ol style="list-style-type: none"><li>1. Please check and connect to the power source properly.</li><li>2. Please empty the dirty water tank.</li><li>3. Please fill up the clean water tank.</li></ol>
There is no steam blasting or the steam volume is small.	<ol style="list-style-type: none"><li>1. The working mode is not steam mode.</li><li>2. The steam holes are clogged.</li><li>3. The clean water tank is short of water.</li></ol>	<ol style="list-style-type: none"><li>1. Switch the working mode.</li><li>2. Use a needle to clear the steam holes.</li><li>3. Add more clean water.</li></ol>
The cleaner doesn't work.	<ol style="list-style-type: none"><li>1. The dirty water tank is full.</li><li>2. The dirty water tank is not installed.</li><li>3. The roller brush is not place properly.</li><li>4. The heating pack is overheated and NTC works.</li></ol>	<ol style="list-style-type: none"><li>1. Please empty the dirty water tank.</li><li>2. Please check and install the dirty water tank.</li><li>3. Please check and install the roller brush.</li><li>4. Cooling the device down then use it.</li></ol>

There are water stains / marks on the floor after use.	<ol style="list-style-type: none"> <li>1. The roller brush is aged.</li> <li>2. The filter is dirty and blocked.</li> <li>3. The suction inlet is blocked.</li> <li>4. The floor sealing strip is aged or broken.</li> </ol>	<ol style="list-style-type: none"> <li>1. Replace the aged brush.</li> <li>2. Clean and dry the filter.</li> <li>3. Clean the suction inlet.</li> <li>4. Contact your local seller to replace a new floor sealing strip.</li> </ol>
--	--	---

If the problems persists after trying the solutions above, please contact your local seller directly.

## Recommended Cleaning / Replacement Frequency

Part	Recommendation
Clean water tank & dirty water tank	Clean after each use.
HEPA	Clean and dry after each use. Replace every 3-6 months.
Filter	Clean after each use
Roller Brush	Clean and dry after each use. Replace it every 3-6 months.
Brush Guard	Clean after each use.
Suction Port	Clean after each use.
Metal Strainer Spoon	Clean after each use
Wheels	Clean every month.
Charging Station	Clean every 2-3 times use.

**Note:**

Above frequency is only for your reference. The final cleaning / replacement frequency should depend on your actual usage.

## **Warranty**

- The Cordless Flomo SE has a 1 year limited warranty against original defects in workmanship or material.
- The warranty only applies to the authorized distributors of Mamibot.
- Improper usage or not in accordance with the user manual will void the warranty.
- The application of force majeure will be invalid.
- Normal reductions, such as battery aging, HEPA aging are not guaranteed.
- ※ Please keep and provide your proof of purchase, S/N when making a claim.

## **Battery Disposal and Removal**

The built-in lithium-ion battery contains substances that are hazardous to the environment. Before disposing of the battery, make sure the battery is removed by qualified technicians and discarded at an appropriate recycling facility.

- The battery must be removed from the appliance before it is scrapped;
- The appliance must be disconnected from the supply mains when removing the battery;
- The battery is to be disposed of safely.

**CAUTION:**

1. Before removing the battery, disconnect the power and run out the battery as much as possible.

2. Unneeded batteries should be discarded at an appropriate recycling facility.
3. Do not expose to high temperature environment to avoid the risks of explosion.
4. Under abusive conditions, liquid may be ejected from the battery. If contact occurs, flush with water and seek medical help.

**Removal Guide:**

1. Unplug the power source.
2. Disassemble the device at a professional institutions, use a proper tool to remove the screws on the back of the robot, and then remove the cover.
3. Unplug the terminals between the battery and PCB board to remove the battery.

## Compliance Standards



The symbol on the product or on its packaging indicates that this product may not be treated as household waste. Instead it should be taken to the appropriate collection point for the recycling of electrical and electronic equipment. By ensuring this product is disposed of correctly, you will help prevent potential negative consequences for the environment and human health, which could otherwise be caused by inappropriate waste handling of this product. For more detailed information about recycling of this product, please contact your local council, your household waste disposal service or the shop where you purchased the product.



The product has been manufactured and found to comply with: 2014/30/EU, 2014/35/EU.

We reserve the right to changes in text, design, and technical specifications which are subject to change without prior notice.

## **MADE IN CHINA**

**Manufacturer:**

Mamibot Manufacturing (Shanghai) Co.,Ltd.  
37B, No.1188, North Kaixuan Road, Shanghai, P.R.C

**Supervisor:**

Mamibot Manufacturing USA Inc.  
One Commerce Center, 1201 Orange St, Wilmington, DE 19899 USA  
Tel: 001 302-428-9888    sales@mamibot.com    [www.mamibot.com](http://www.mamibot.com)

